

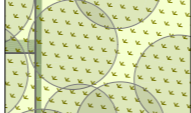
	Bâtiment A TOITURE TUILES ROMANE CANAL TONS MELES PENTE 33% + FENETRE DE TOIT 94*118 ALU LAQUE GRIS CLAIR		TOITURE BAC ACIER GRIS ZINC PENTES 6 et 10%		TOITURE BAC POLYCARBONATE TRANSLUCIDE SIMPLE PEAU (LOCAUX 2 ROUES)		ESPACE VERT ENGAZONNE + ARBRES PLANTES/EXISTANTS		ACCES VL / PMR EN GRAVILLONS CALCAIRE STABILISES		PLACES PK MELANGE TERRE/PIERRE
	Bâtiment B TOITURE ONDULÉ FIBROCIMENT FLAMMÉ + TUILES TIGE DE BOTTE TONS MELES PENTE 16% + FENETRE DE TOIT 94*118 ALU LAQUE GRIS CLAIR		TOITURE ÉTANCHÉITÉ + GRAVILLONS (+Panneaux SOLAIRES BÂT. C)								

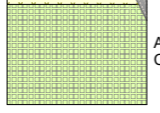
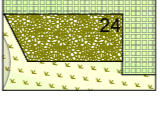
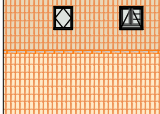
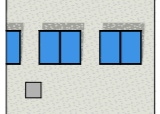
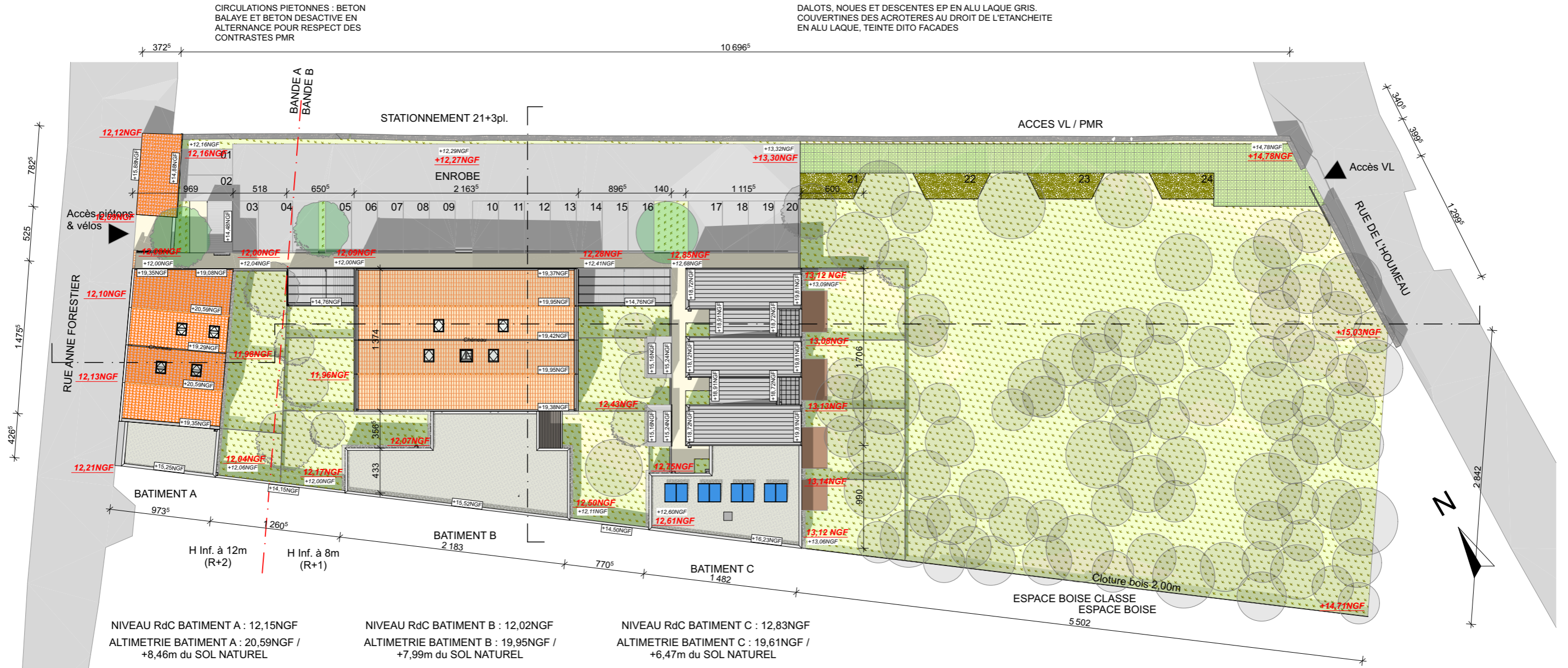

12,28NGF COTES NGF TN AVANT TRAVAUX AUX EXTREMITES DES BATIMENTS
+12,41NGF COTES NGF TN APRES TRAVAUX
+19,37NGF COTES NGF DES CONSTRUCTIONS