

***N.B. WARNING! FOR INSTALLATION ON MODEL 2022 -->**
 it is essential to use the bracket cod.3015305501 on the manifold to avoid damaging the original fairing.

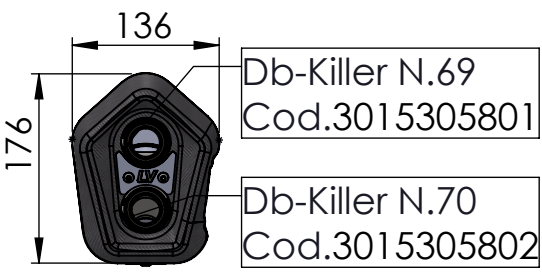

LV-12 silencer RHS
 Titanium
 Cod.3015305486

Aluminium spacer
 $\varnothing 27 \times 8,5$ Cod. 204321

Aluminium spacer
 $\varnothing 25-18 \text{ L}=40 \varnothing 8,5$
 Cod. 202499

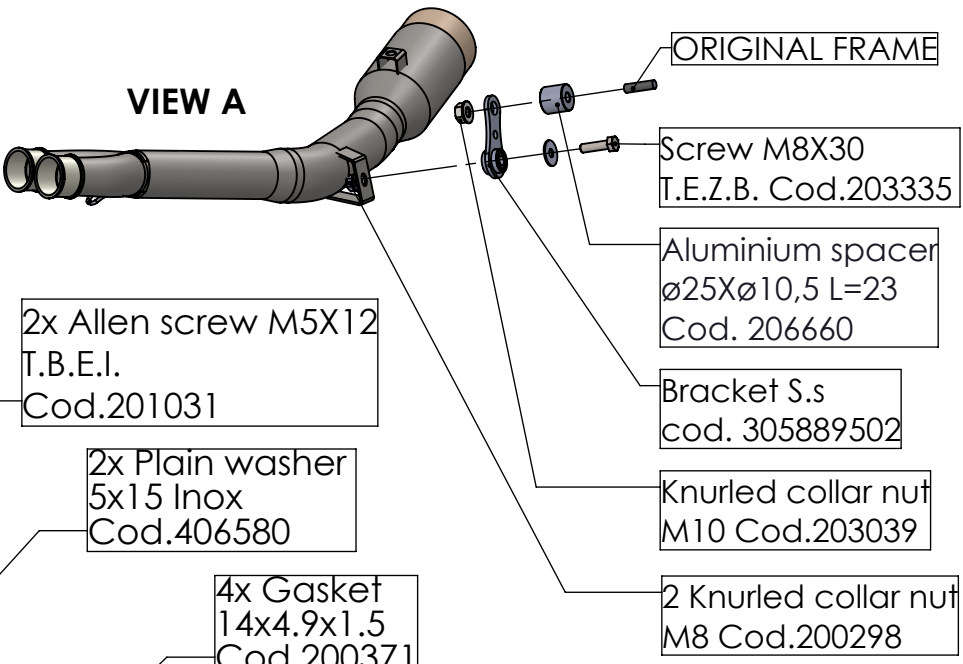

2x Allen screw M5X12
 T.B.E.I.
 Cod.201031

2x Plain washer
 5x15 Inox
 Cod.406580

4x Gasket
 14x4.9x1.5
 Cod.200371

ORIGINAL FRAME

Screw M8X30
 T.E.Z.B. Cod.203335

Aluminium spacer
 $\varnothing 25 \times 10,5 \text{ L}=23$
 Cod. 206660

Bracket S.s
 cod. 305889502

Knurled collar nut
 M10 Cod.203039

2 Knurled collar nut
 M8 Cod.200298

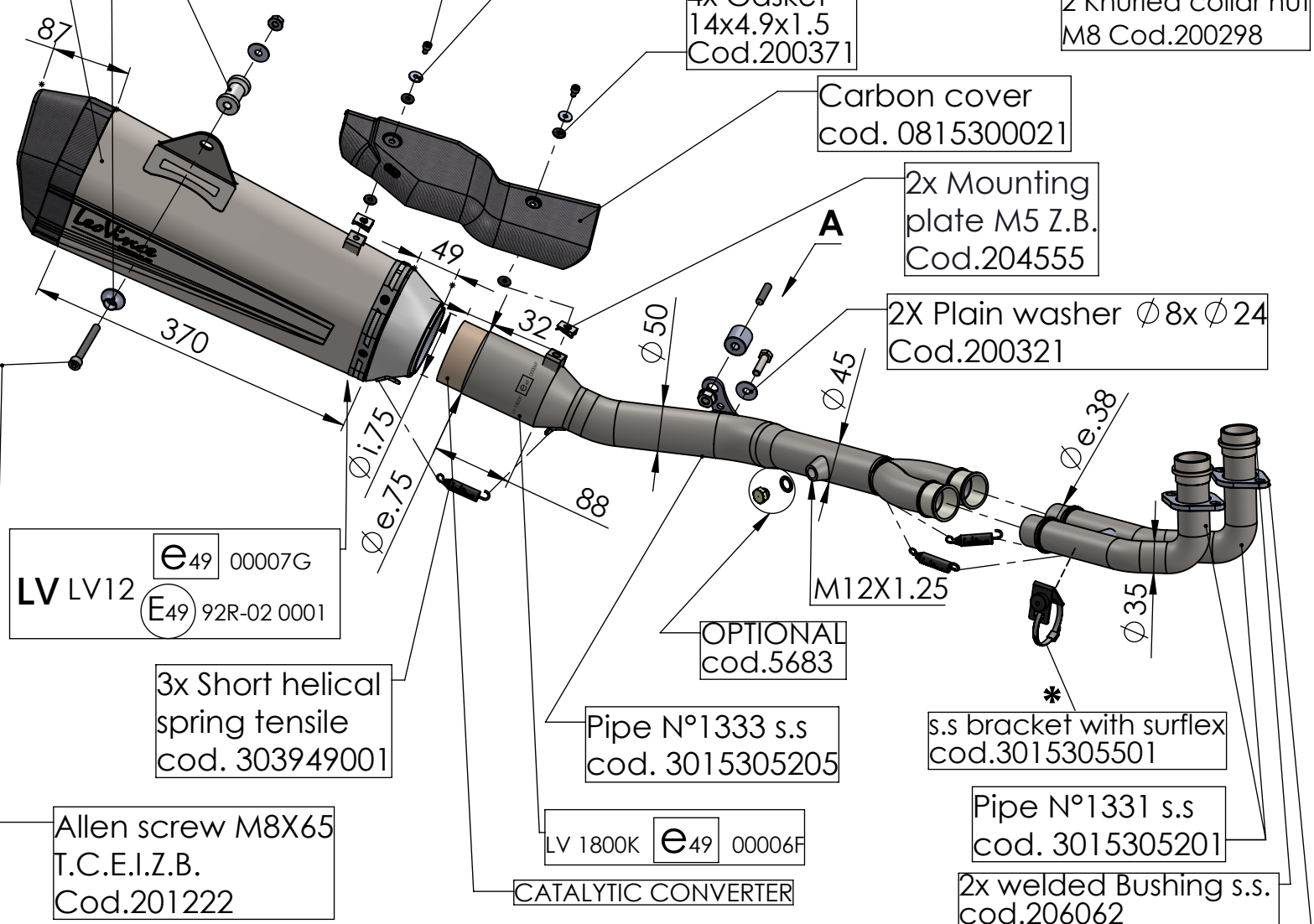

LV LV12 e_{49} 00007G
 E_{49} 92R-02 0001

3x Short helical
 spring tensile
 cod. 303949001

Allen screw M8X65
 T.C.E.I.Z.B.
 Cod.201222

LV 1800K e_{49} 00006F

CATALYTIC CONVERTER

Pipe N°1333 s.s
 cod. 3015305205

OPTIONAL
 cod.5683

M12X1.25

2X Plain washer $\varnothing 8 \times \varnothing 24$
 Cod.200321

2x Mounting
 plate M5 Z.B.
 Cod.204555

Carbon cover
 cod. 0815300021

$\varnothing 50$

A

A

A

A

A

A

A

A

A

A

A

A

ART. 15305TK

YAMAHA T-MAX 560/TECH MAX

it is advisable to optimize the carburation by remapping the stock ECU or by adopting an additional ECU unit.

SLIP-ON - LV-12 - TITANIUM - APPROVED

WARNING

2x Flange 25B s.s. sp.6mm
 cod.200560

Pipe N°1331 s.s
 cod. 3015305201

2x welded Bushing s.s.
 cod.206062

s.s bracket with surflex
 cod.3015305501

*

*

*

*

*

*

*

*

*